

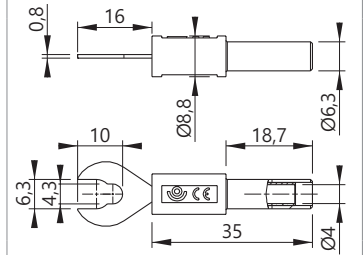

# Ada3034

ADAPTER WIDE FORK / Ø4MM FEMALE  
ADAPTATEUR FOURCHE LARGE / FEMELLE Ø4  
KABELSCHUH-ADAPTER BREITE GABELFORM / Ø4MM BUCHSE



Reference  
Référence  
Bestell-Nr **Ada3034-#**

Rated voltage Tension assignée Bemessungsspannung	Rated current Intensité assignée Bemessungsstrom	Contact parts Contacts Kontaktteile	Insulation Isolant Isolierteile	Colours [#] Couleurs [#] Farben [#]												
≤30VAC ≤60VDC	36A	Ni coated brass Laiton nickelé Messing vernickelt	PA6	<table border="1"> <tr> <td>R</td><td>N</td><td>BL</td><td>V</td><td>J</td><td>BC</td> </tr> <tr> <td>2</td><td>0</td><td>6</td><td>5</td><td>4</td><td>9</td> </tr> </table>	R	N	BL	V	J	BC	2	0	6	5	4	9
R	N	BL	V	J	BC											
2	0	6	5	4	9											

x10

# Ada204

ADAPTER Ø2MM MALE PLUG / Ø4MM FEMALE  
ADAPTATEUR FICHE MÂLE Ø2MM / FEMELLE Ø4MM  
STECKADAPTER Ø2MM STECKER / Ø4MM BUCHSE

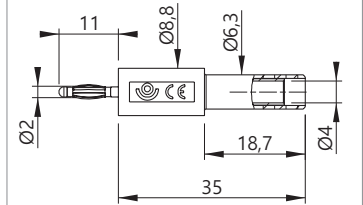

Reference  
Référence  
Bestell-Nr **Ada204-#**

Rated voltage Tension assignée Bemessungsspannung	Rated current Intensité assignée Bemessungsstrom	Contact parts Contacts Kontaktteile	Insulation Isolant Isolierteile	Colours [#] Couleurs [#] Farben [#]												
≤30VAC ≤60VDC	36A	Ni coated brass Laiton nickelé Messing vernickelt	PA6	<table border="1"> <tr> <td>R</td><td>N</td><td>BL</td><td>V</td><td>J</td><td>BC</td> </tr> <tr> <td>2</td><td>0</td><td>6</td><td>5</td><td>4</td><td>9</td> </tr> </table>	R	N	BL	V	J	BC	2	0	6	5	4	9
R	N	BL	V	J	BC											
2	0	6	5	4	9											

x10

# Ada205

ADAPTER Ø2MM FEMALE SOCKET / Ø4MM FEMALE  
ADAPTATEUR DOUILLE FEMELLE Ø2MM / FEMELLE Ø4MM  
STECKADAPTER Ø2MM BUCHSE / Ø4MM BUCHSE

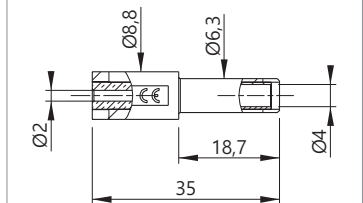

Reference  
Référence  
Bestell-Nr **Ada205-#**

Rated voltage Tension assignée Bemessungsspannung	Rated current Intensité assignée Bemessungsstrom	Contact parts Contacts Kontaktteile	Insulation Isolant Isolierteile	Colours [#] Couleurs [#] Farben [#]												
≤30VAC ≤60VDC	10A	Ni coated brass Laiton nickelé Messing vernickelt	PA6	<table border="1"> <tr> <td>R</td><td>N</td><td>BL</td><td>V</td><td>J</td><td>BC</td> </tr> <tr> <td>2</td><td>0</td><td>6</td><td>5</td><td>4</td><td>9</td> </tr> </table>	R	N	BL	V	J	BC	2	0	6	5	4	9
R	N	BL	V	J	BC											
2	0	6	5	4	9											

x10